

PLAN SHOWING THE ADDITIONAL CONSTRUCTION OF
A RESIDENCE IN P.No. 148 AT S.No. 78/2, ELIM NAGAR,
PERUNGUDI VILLAGE, SAIDAPET TALUK, CHENGALPUT
M.G.R. DISTRICT.

SCALE 1" = 8'0" OR 1:100

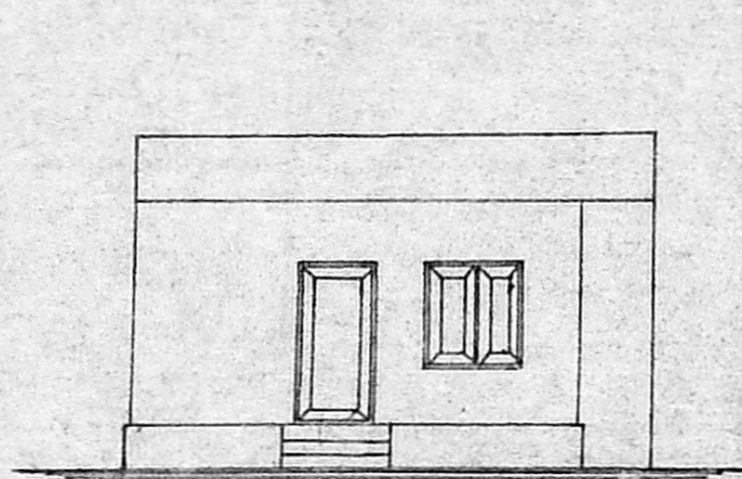

ELEVATION

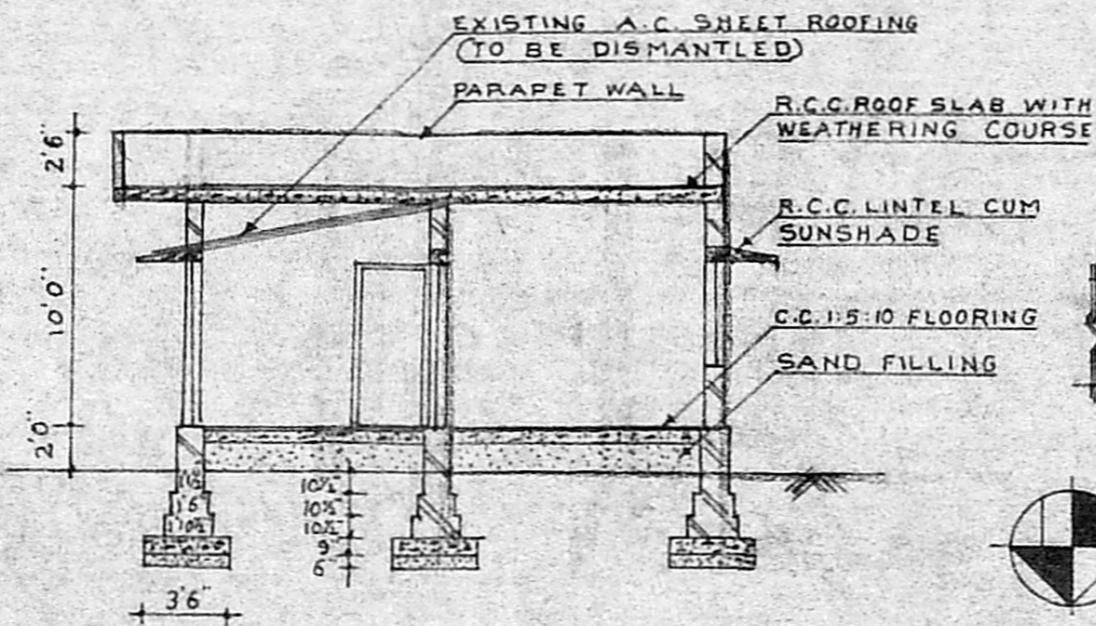

SECTION ON XX

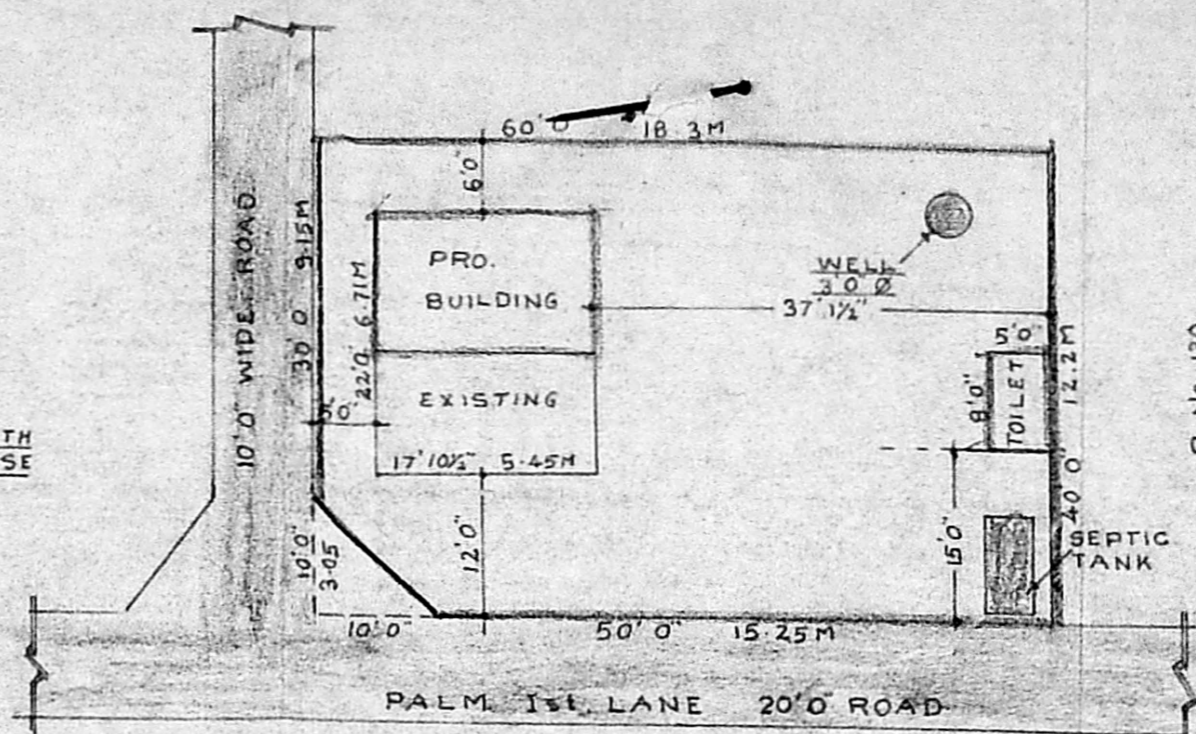

SITE PLAN
SCALE 1:200

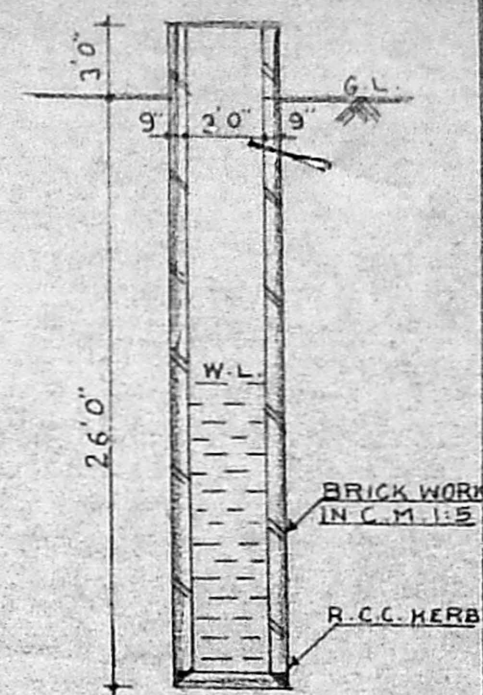

SECTION OF 30" Ø WELL

Planning Form No. 195/153
APPROVED
 SUBJECT TO THE CONDITIONS IN THIS OFFICE LETTER
 No. A2/10532/92
 PALM ROAD 20'0"
 FOR MEMBER SECRETARY
 MADRAS METROPOLITAN
 DEVELOPMENT AUTHORITY
 MADRAS - 600 008.

KEY PLAN
NOT TO SCALE

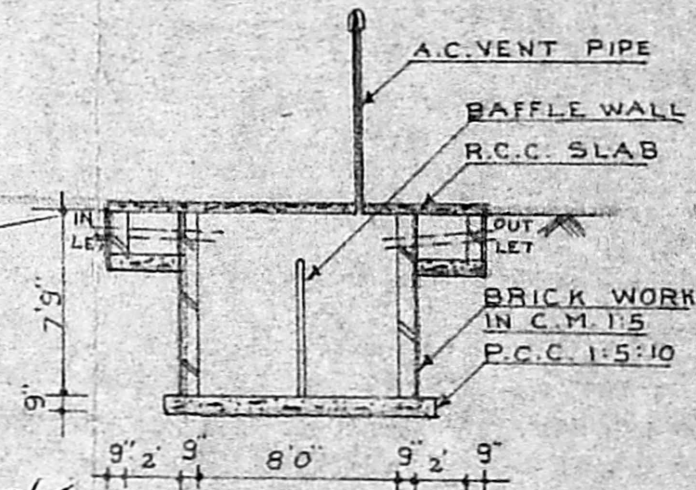

SECTION OF SEPTIC TANK

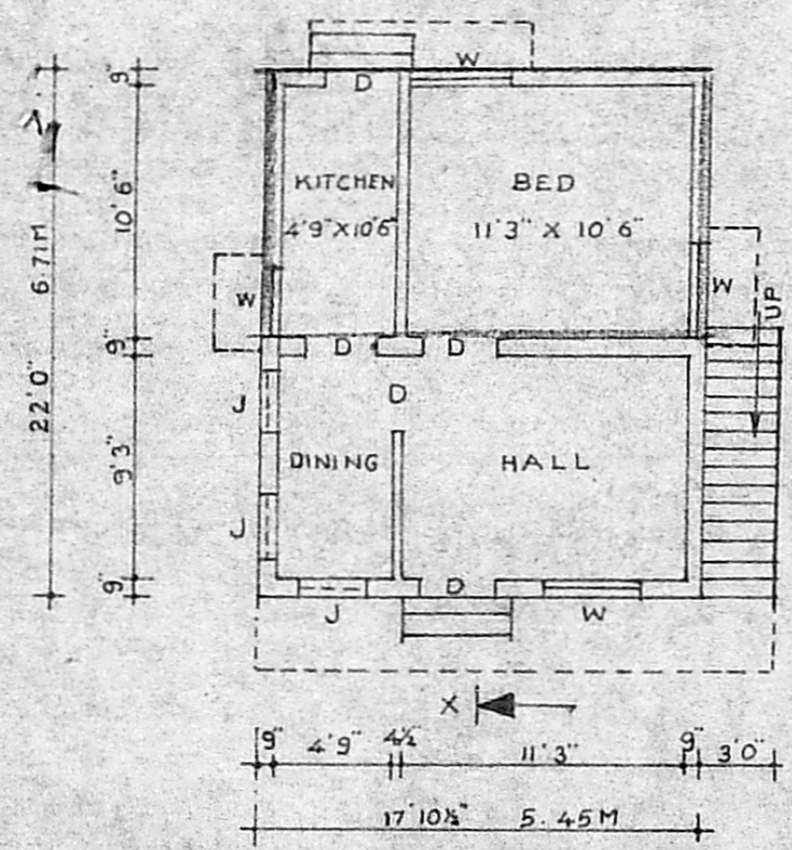

PLAN

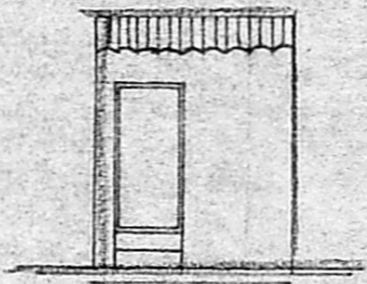

ELEVATION

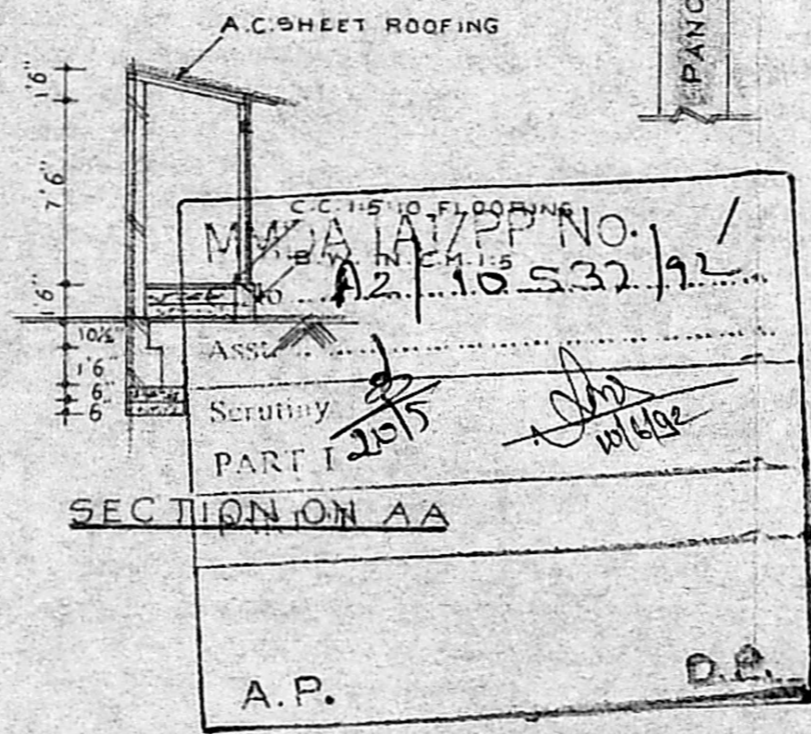

SECTION ON AA

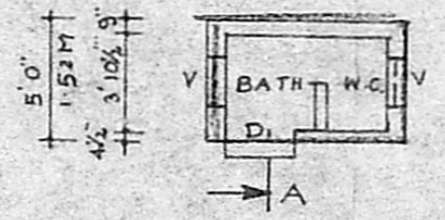

PLAN OF TOILET

Plot area = 218.55 m²

Slab area = (22m x 7.87m) + (3 x 80) + (8 x 5)

= 523.25 Sft = 48.66 m²

FSS = $\frac{48.66}{218.55} = 0.22$ 22%

AREA DETAILS

PLOT AREA	: 2350 SFT (218.4 M ²)
PLINTH AREA	
RESIDENCE (EXISTING)	: 192.16 SFT (17.85 M ²)
" (PROPOSED)	: 201.09 SFT
"	: 40.00 SFT (3.71 M ²)

COLOUR INDEX

PROPOSED	
EXISTING	
DISMANTLED	
BOUNDARY	
ROAD	

SCHEDULE OF JOINERY

D	PANNELED DOOR	3'0" x 7'0"
D.	- DO -	2'6" x 6'6"
W	PANNELED WINDOW	4'0" x 4'6"
W.	- DO -	3'0" x 4'6"
Y	VENTILATOR	2'0" x 1'6"
J	JOLLY	

R. Gu & Wilson

OWNER

J. S. Arivazhagan
 J. S. ARIVAZHAGAN, D.C.E.
 Class II Licensed Surveyor No. 26,
 CORPORATION OF MADRAS,
 PERUNGUDI TOWN PANCHAYAT
 CONSULTING ENGINEER & CONTRACTOR,
 NO. 6, THIRUMALAI NAGAR,
 PERUNGUDI, MADRAS - 600 096
 PHONE:

LICENSED SURVEYOR